

SECTION C-C
SCALE 1:50

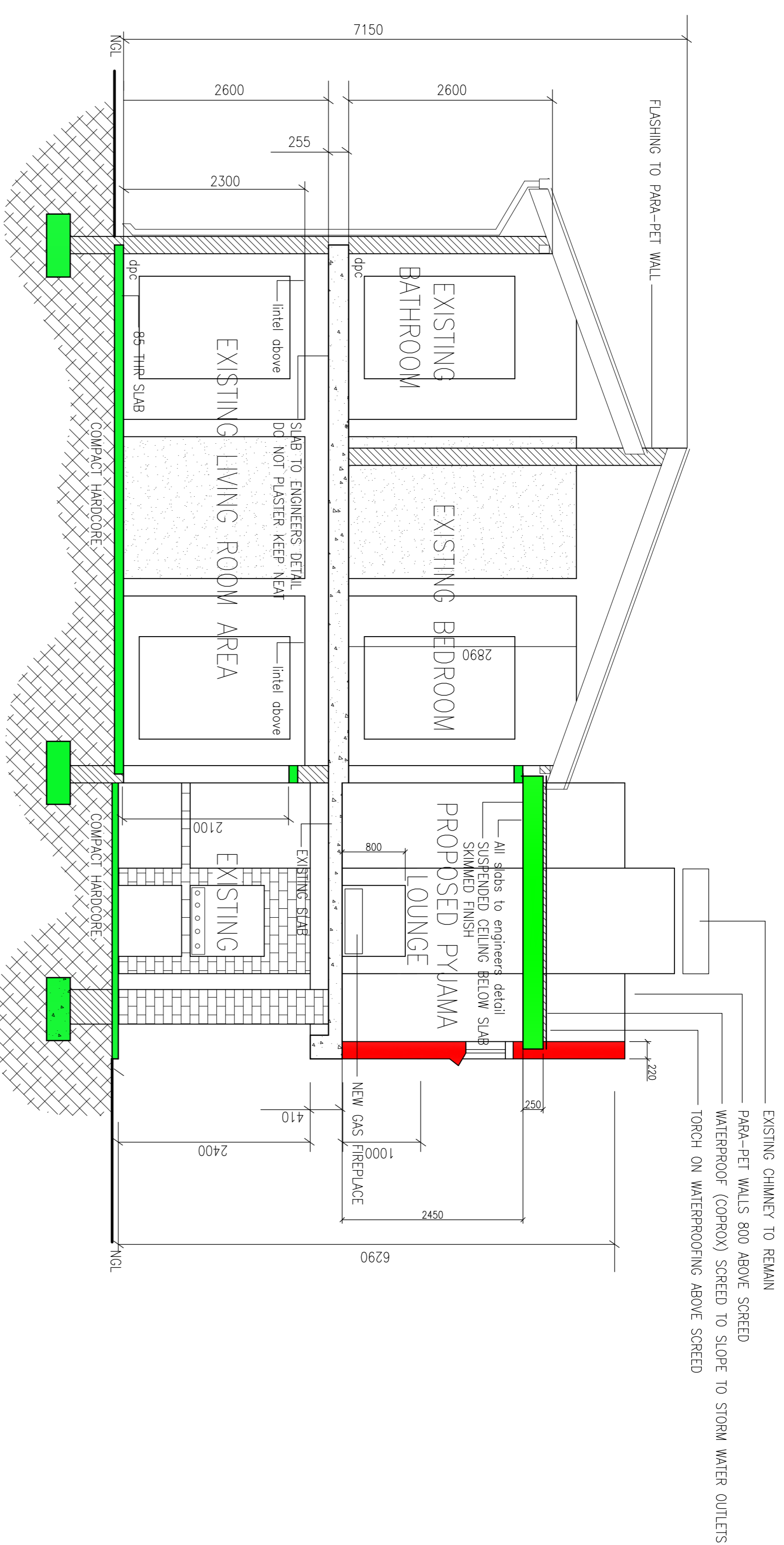

SECTION B-B
SCALE 1:50

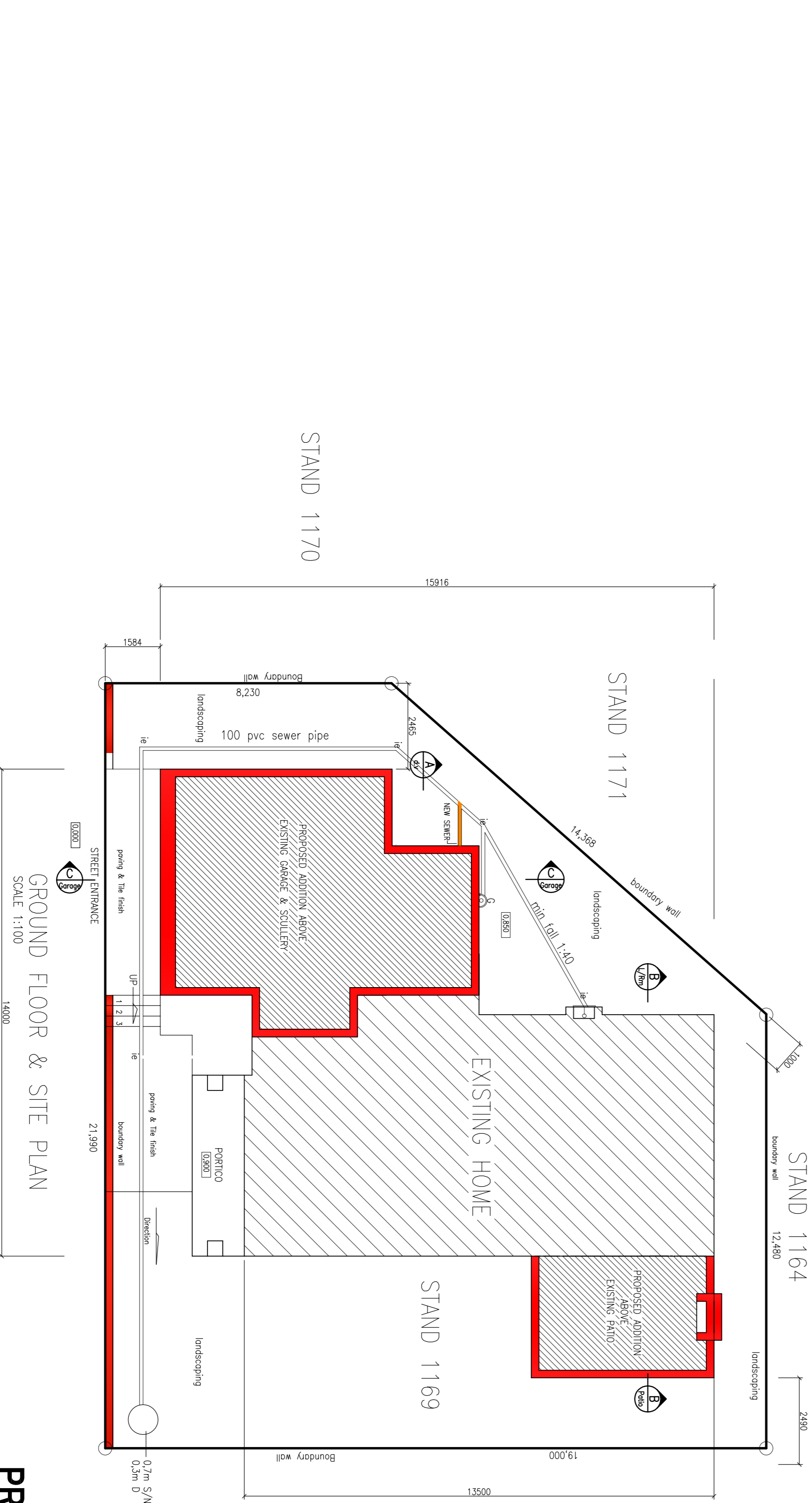

GROUND FLOOR & SITE PLAN
SCALE 1:100

PROPOSED SECTIONS AND SITE LAYOUT

FOR MR & MRS De La Guerre
STAND 1169 STONERIVER
BEVERLEY EXT

SHEET 2 OF 2

ARCHITECTURAL GENERAL NOTES

- 1) Quality of all materials and workmanship to comply with the relevant SABS specifications and shall conform to the minimum standards specified in the standard premises.
- 2) The Contractor is responsible for the correct setting out of the building. The Architect is to verify this by checking these dimensions against the drawings before putting work in hand. The Contractor is to hand in DPC's whether or not these are shown on the drawings to all external brick walls at each floor, beam and parapet level and to all doors, windows, grilles and other openings in external walls.
- 3) Damp proofing and waterproofing materials to be applied in accordance with SABS Code of Practice 021.
- 4) All ground slabs to be RC slabs to Engineer's details and on US Green 375 micron waterproofing membrane on well-compacted fill.
- 5) All raised levels refer to raw concrete unless otherwise indicated.
- 6) All building work to be carried out in accordance with National Building Regulations.

PLUMBING & DRAINAGE

- 1) 100 dia. U.P.V.C. sewer pipe drain with 100mm fall at 1200 of sewer pipe.
- 2) 100 dia. C.A.P. (F.E.S.) at head of drain, with 25mm fall at 1200.
- 3) Rodding eyes of 25 metre intervals.
- 4) Inspection eyes (I.E.S.) at all junctions of drain, and to have marked covers at ground level.
- 5) Drain pipes under building to be enclosed in minimum of 150mm concrete.
- 6) All waste fittings to have 60mm re-seal traps. All waste pipes to be 38 dia. and to be accessible over the entire length for cleaning and repairs.
- 7) All soil fittings with a vertical discharge greater than 1 220 to have minimum 50 dia. anti-siphon vent pipes (A.S.V.P.'s).
- 8) Rainwater downpipes (R.M.D.P.'s) to discharge a minimum of 25mm from any level of gutter work to be carried out in accordance with local authorities drainage by-laws and regulations.
- 9) No bends or junctions in or under floor slab.
- 10) Soil pipes to be 102mm diameter.
- 11) All waste pipes to be minimum 38mm diameter.
- 12) All common waste pipes to be 50mm diameter.
- 13) All common waste pipes to be 50mm diameter.

- 1) Glass between 0 & 0.75 sq. meter to be 3mm thick.
- 2) Glass between 0.75 & 1.5 sq. meter to be 4mm thick.
- 3) All glazing shall comply with the requirements contained in SABS 0137.
- 1) Roof pitch shall be 20 deg
- 2) On 76 x 38 battens on edge at 320 centers, 75mm thick, 100mm layer between ceiling and roof covering. 75mm thick compact roofing felt.
- 3) All timber shall comply with SABS 563 soft wood structural timber and must be grade 6 timber. Trusses to be tied down with galvanized hoop-iron, threaded through 4 courses of brickwork.
- 4) Chlorinated sheet-iron flashing at all changes of roof level and all parapet walls.
- 5) 100 x 75 powder coated aluminum gutters and downpipes.
- 6) Skimmed ceilings on 38 x38 bracing

Any discrepancies must be brought to the attention of ELS & Associates at once. All work shall comply with the requirement of SABS 1206 to SABS 1209. All exposed concrete work to be off-white finish. Cement extenders to be used only if approved by engineer.

Copyright ELS & ASSOCIATES



ELS
& ASSOCIATES
ARCHITECTURAL STUDIO

P O BOX 10263 FORUMS CROSSING
2065
TEL: 489 4043
FAX: 0866 892 694
CELL: 082 442 6346
E-MAIL: enquiries@els.co.za

REV 20s @ 18/07/11

registered S.A.C.A.P member

PLAN
DRAWN
DESIGNED
CHECKED K.E.S.

W/D/001/01/08/FF
STONERIVER

ELS & Associates arch studio